

Henry Graham's

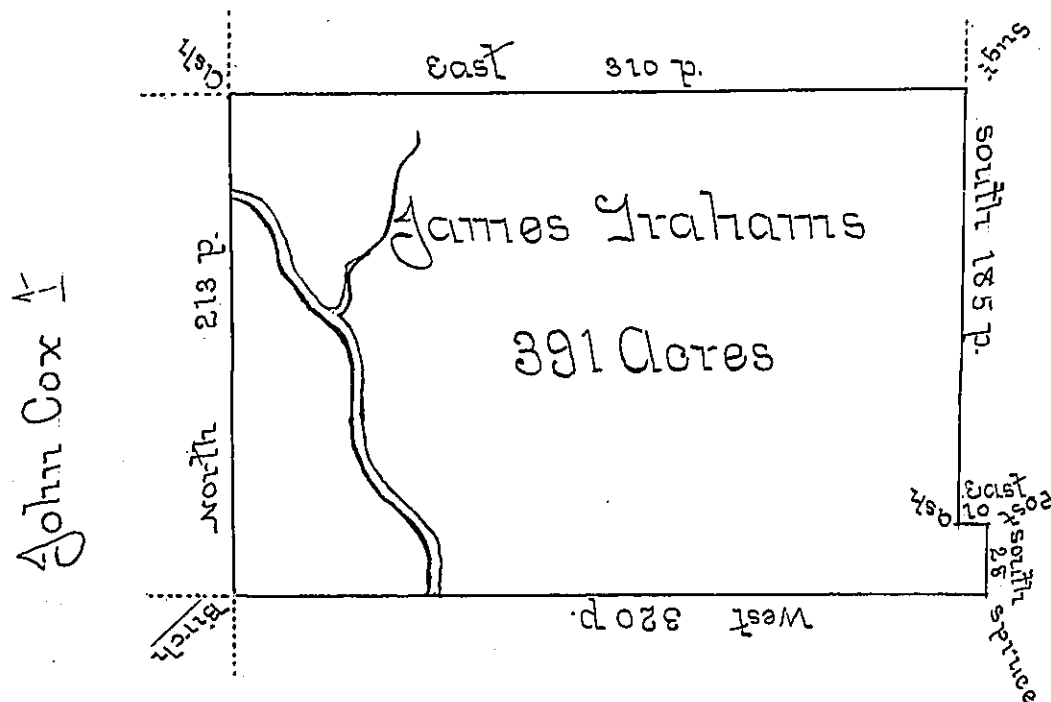

Situate on the West Side of French Creek in Allegheny County Containing 391 Acres and 150 perches and Allowance of Six p Cent for Roads &c.. Surveyed the 11<sup>th</sup> Day of ~~the~~ June 1795. In pursuance of his Improvement. Dated the 16<sup>th</sup> Day of April 1795

To Daniel Brodhead Esqr } Wm Power D.H. SE  
 Surveyor General

IN TESTIMONY that the above is a copy of the original remaining on file in the Department of Internal Affairs of Pennsylvania, made conformably to an Act of Assembly approved the 16th day of February, 1833, I have hereunto set my Hand and caused the Seal of said Department to be affixed at Harrisburg, this second day of February 189

*James W. Patton*  
 Secretary of Internal Affairs.